

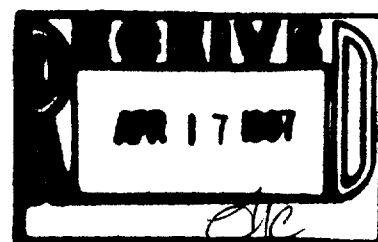

PARCEL B: LOTS 3, 4 AND 5 IN BLOCK 4 AND LOTS 1 AND 2 IN BLOCK 5, AND THAT PART OF LOTS 3 AND 4, BLOCK 5, LYING SOUTHWESTERLY OF A LINE BEGINNING 1 1/2 RODS NORTH OF THE SOUTHWEST CORNER OF LOT 4, BLOCK 5, THENCE RUNNING SOUTHEASTERLY ACROSS LOTS 4 AND 3 AND FORMER DOUGLASS STREET, NOW VACATED, TO A POINT 1 1/2 RODS SOUTH OF THE NORTHWEST CORNER OF LOT 3, BLOCK 6, ALL IN BRIGHAM'S ADDITION TO THE VILLAGE OF SHARON, TOGETHER WITH A PARCEL OF LAND ADJOINING SAID LOTS IN SAID BLOCKS DESCRIBED AS THE WEST 1/2 OF FORMER DOUGLASS STREET, NOW VACATED, AND BEING BOUNDED ON THE SOUTH BY THE SOUTH LINE OF LOT 3, BLOCK 4 EXTENDED EAST AND ON THE NORTH BY A LINE EXTENDING EAST FROM THE POINT OF INTERSECTION OF THE EAST LINES OF LOTS 2 AND 3, BLOCK 5, WITH A LINE BEGINNING 1 1/2 RODS NORTH OF THE SOUTHWEST CORNER OF LOT 4, BLOCK 5, AND RUNNING THENCE SOUTHEASTERLY ACROSS LOTS 4 AND 3, AND FORMER DOUGLASS STREET, NOW VACATED, TO A POINT 1 1/2 RODS SOUTH OF THE NORTHWEST CORNER OF LOT 3, BLOCK 6, ALL IN BRIGHAM'S ADDITION TO THE VILLAGE OF SHARON.

PARCEL D: LOTS 4 AND 5 IN BLOCK NO. 6 OF BRIGHAM'S ADDITION TO THE VILLAGE OF SHARON, WALWORTH COUNTY, WISCONSIN.

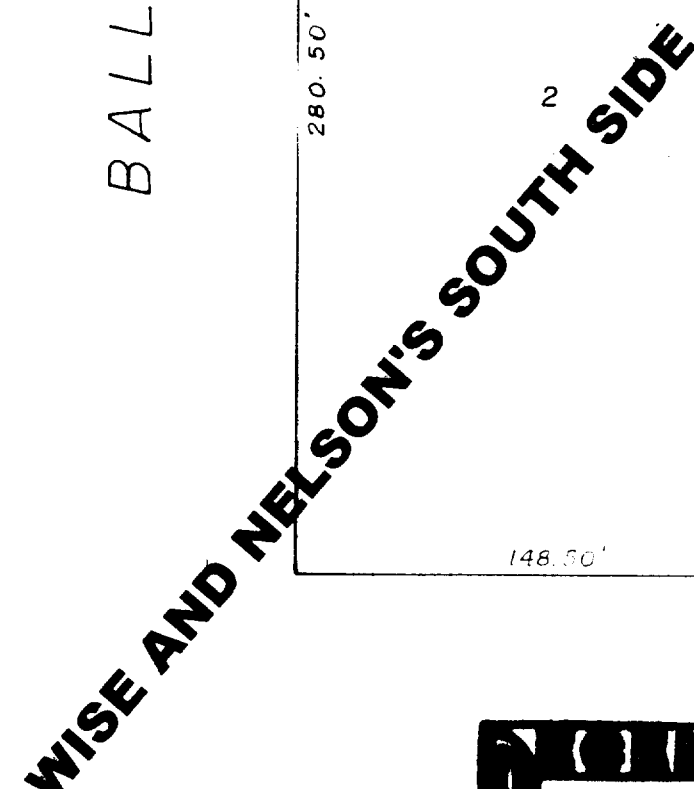

Scale 1" = 60'

Iron stakes set 

Iron stakes found 

Distances are given in feet & decimals

DIMENSIONS OR ANGLES ARE NOT TO BE ASSUMED FROM SCALING.

A circular professional seal for a Wisconsin Land Surveyor. The outer ring contains the text "WISCONSIN" at the top and "LAND SURVEYOR" at the bottom, separated by two five-pointed stars. The inner circle contains the text "MATTHEW J. STAHL", "5-788", "WOODSTOCK", and "IL" in a stacked format. The seal has a decorative, dotted border.

This is to certify that we have surveyed the above described property according to the Official Record, and the above plat correctly represents said survey.

WIS. PROF. LAND SURVEYOR NO. 788

008-292